

## RETRACTA (Series 2)

### INSTRUCTION MANUAL FOR ALL MODELS EXCEPT OXY-ACETYLENE and OXY-LPG

#### INTRODUCTION

Thank you for purchasing a Macnaught Auto Rewind Hose Reel.

The Macnaught range of hose reels are a breakthrough in industrial quality hose reel design, performance, durability, versatility and cost. The efficiency, safety and convenience benefits of auto rewind hose reels are now available for most situations where a hose is required.

Manufactured from the highest quality weather resistant materials, the tough high – impact polypropylene is U.V. stabilised, designed for all purpose corrosion-free durability. The rewind mechanism is lubricated and sealed for trouble-free operation.

This retractable hose reel promotes a neat and tidy good looking work area, reducing the possibility of accidents, and improves the work environment. Safety is enhanced by low recoil tension even with the hose fully extended.

With your appropriate care, combined with the Macnaught guarantee of dependable after sales service, you will be assured of continuous safe, efficient and reliable product operation.

#### GENERAL INFORMATION

This manual assists you in operating and maintaining your new Retractable hose reel. The information contained will help you ensure many years of dependable performance and trouble free operation.

Please take a few moments to read through this manual before installing and operating your Retractable reel. If you experience problems with the product, refer to the procedures contained within this instruction manual. If you require further assistance please contact your local Macnaught distributor, or local Macnaught service centre.

#### IMPORTANT INFORMATION

**PLEASE READ THIS SAFETY INFORMATION CAREFULLY BEFORE USE.**

Please read and retain this instruction manual to assist you in the operation and maintenance of this quality product.

Your safety is important to us. Please read, understand and follow all safety instructions listed below. Some of these instructions alert you to the potential for personal injury. "Cautions" listed throughout the manual advise of potential practices or procedures which may cause damage to your equipment.

Make sure all operators have access to adequate instructions about safe operating and maintenance procedures.

This hose reel contains a pre-tensioned spring inside the drum assembly. For safety reasons the drum assembly is a non-repairable item. **DO NOT** under any circumstances try to open the drum assembly. A new drum assembly will be required if the spring is damaged.

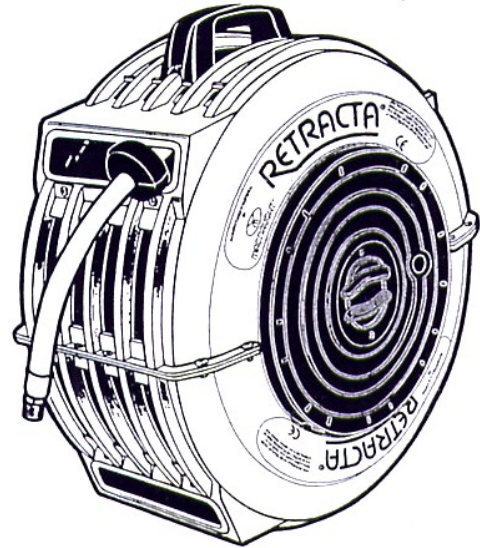

**DO NOT** exceed the maximum working pressure stated on the product label.

The maximum installation height is 4.5 meters (15ft) above the ground.

The maximum weight of hose end tools is 2kg (4lb).

This reel contains a positive latching mechanism, which enables the reel to be mounted in any position.

#### INSTALLATION

- Attach the carry handle to the reel casing above the reel/hose mouth, using the screws provided.
- The reel can be mounted in any position. The most common mounting positions are shown below. (Refer fig 1,2,3,4)

If you choose the most popular positions (1) and (2) you should use the standard (BU100) bracket. If using positions (3) and (4) you will need the optional bracket (BB100).

Fig.1 Wall / BU100



Up to 6ft above ground

Fig.2 Overhead / BU100

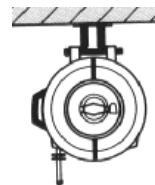

Up to 15ft above ground

Fig.3 Floor / Bench / BB100

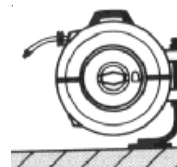
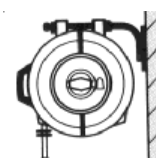

Fig.4 High Wall / BB100



- c) Fix mounting bracket in required location and position reel onto bracket. Brackets can be padlocked for additional security.
- d) Connect supply hose to reel inlet allowing sufficient space for reel to swivel 180° on bracket. Swivel rotation can be avoided (in the overhead position only) by adding the locking bracket (RB9) supplied.

## POSITIVE LATCH OPERATION

Pull out the hose to the required length.

**Note:** A clicking noise can be heard every half revolution of the drum.

**To latch the reel,** allow the reel to slowly retract after hearing the 1st, 2nd or 3rd click.

**To unlatch the reel,** slowly pull out the hose until the clicking noise stops, then let the hose slowly retract until the hose stopper rests against the reel mouth.

### CAUTION

**To prevent injury or damage occurring, do not let go of the hose during rewinding.**

## MAINTENANCE

This section details the step-by-step procedures that you may require for the general use and maintenance of your reel. Please keep this instruction manual for future reference.

## REMOVAL / REPLACEMENT OF INLET CONNECTION SIDE PLATE

- a) Pull the hose out until it is fully extended and allow the hose to latch after hearing the 1st, 2nd or 3rd click.
- b) Place reel on a clean bench with the inlet side plate (1) face up. Remove screw located at the edge of the inlet plate. Rotate plate clockwise.
- c) Swivel assembly and hose will come away attached to the inlet side plate.
- d) To replace inlet side plate, suspend reel between your body and edge of bench. Reposition plate and turn counter-clockwise and relocate the side screw.

## SPRING TENSION AND LATCH SIDE PLATE REMOVAL

- a) Place reel on a clean bench with latching plate (9) face up.
- b) Release spring tension by opening tension plate (8) and place handle of a pair of pliers in the exposed slots. Grip the pliers firmly and remove the two screws holding the tension plate (8) and carefully allow the tension plate to slowly unwind counter-clockwise.
- c) Remove screw holding tension plate and remove tension plate. Remove screw located at the edge of the latching plate. Turn latching plate clockwise and remove, this will expose the latching cup assembly.
- d) To replace latching plate, suspend reel between your body and edge of the bench. Reposition the plate and counterclockwise. Relocate side screws, replace tension plate and fixing screw.

- e) Reload spring tension by using the same tool (as in step B) and wind tension plate clockwise until hose stopper is firmly against the reel mouth, some resistance will be felt. Then, add approximately six (6) complete 360° tension turns. Hold the tension plate in this position, align dimples on tension plate latching side plate and replace the two screws. Close tension plate and cover.

## SWIVEL SEAL REPLACEMENT

- a) Place reel on a clean bench with inlet side plate (1) face up
- b) Remove the inlet side plate (Refer Removal/Replacement Inlet Connection Side Plate).
- c) Remove circlip (4) from end of swivel shaft assembly (2) and slide the inlet shaft from the swivel body(3).
- d) Carefully remove the existing O-Rings by lifting O-Rings out from grooves using a small screwdriver. With O-Rings extended, cut through the O-Ring onto the screwdriver face. Be careful you do not score O-Ring grooves.

### CAUTION

**Do not damage or score inlet shaft surface when removing or cutting O-Ring.**

- e) Before fitting new O-Rings ensure that both inlet shaft and swivel are thoroughly wiped clean.

## SWIVEL RE-ASSEMBLY

- a) Slide inlet shaft back into the swivel body and replace circlip.
- b) Slide inlet shaft back into the drum assembly (5), pushing complete unit home.
- c) Replace inlet side plate. (Refer to "Removal/Replacement Inlet Connection Side Plate").

## HOSE REPLACEMENT

- a) Pull the hose out until it is fully extended and allow the hose to latch after hearing the 1st, 2nd or 3rd click.
- b) Remove the inlet side plate (1) (Refer "Removal / Replacement of Inlet Connection Side Plate"). The swivel shaft assembly (2) will come away attached to the inlet side plate.
- c) Remove hose from swivel body (3). Remove remaining old hose from the mouth of the reel.
- d) Use only recommended length and type of replacement hose.
- e) Feed the new hose through top of reel mouth and into opening on reel drum which gives access to the swivel compartment. Replace and secure the internal hose stopper 5" from the end of hose assembly. Reconnect hose.
- f) Replace inlet side plate (1) (Refer "Removal/Replacement Inlet Connection Side Plate").
- g) Place the reel in a vertical position and while holding the reel pull the hose out and switch to free run mode. The hose will now rewind. Carefully guide the hose onto the drum
- h) If the replacement hose is the same length as the old hose no tension adjustment is necessary. If tension adjustment is required follow the 'Spring Tension procedure ( Refer "Spring Tensioning and Latch Side Plate Removal")

### CAUTION:

**Test reel for leaks prior to any further use.**

## PARTS DIAGRAM

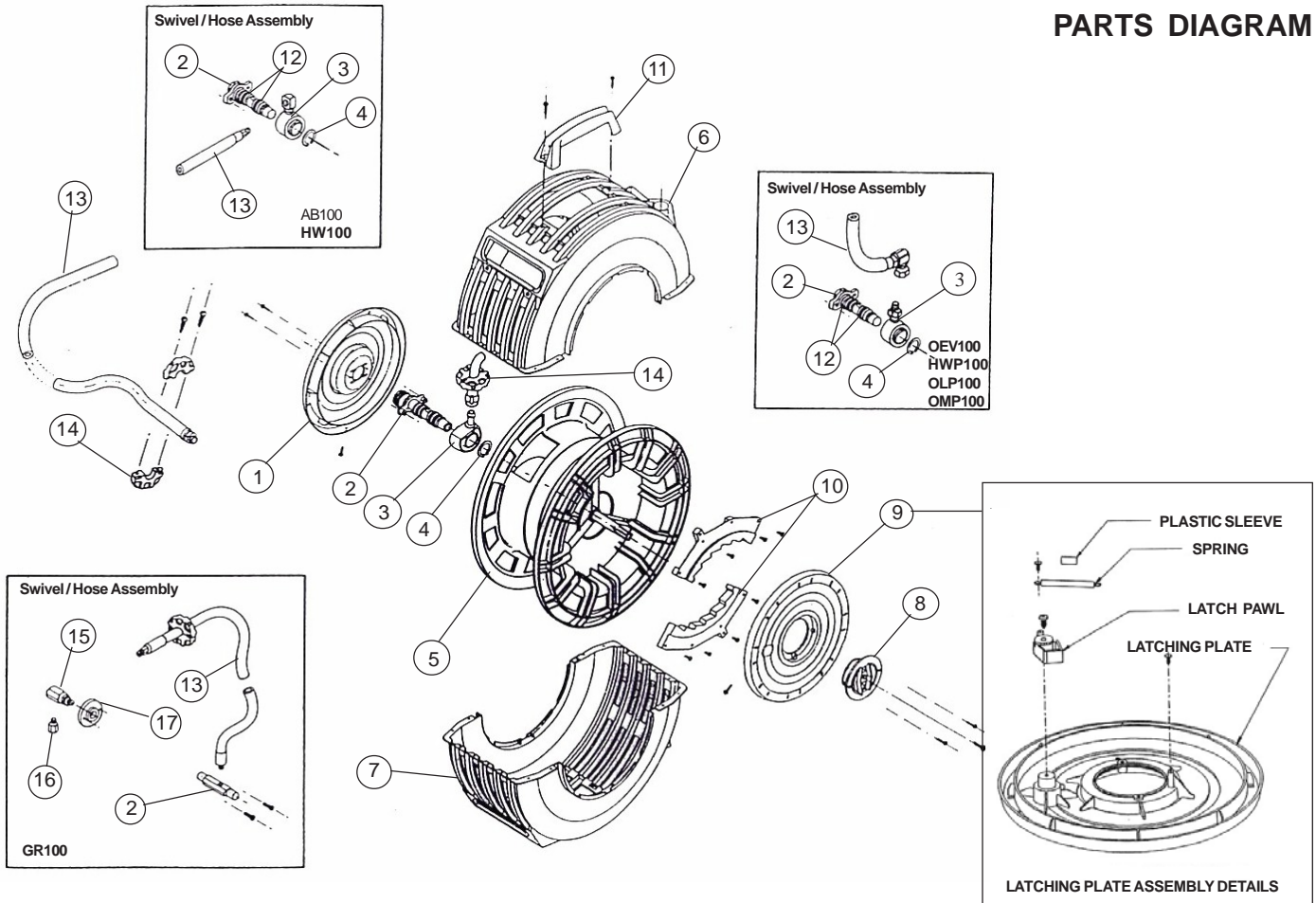

## SPARE PARTS LIST

ITEM	DESCRIPTION	PART / SET	AB100	AR100	AR200	AW100	AW200	CW100	DR100	GR100
1	INLET SIDE PLATE		order RP34s	order RP34s	order RP34s	order RP34s	order RP34s	order RP34s	order RP34s	order RP34s
2	SWIVEL SHAFT									
3	SWIVEL BODY	Seals incl'd	RS100s (BSP)	RS27s (NPT) RS26s (BSP)	RS48s (NPT) RS26s (BSP)	RS27s (NPT) RS26s (BSP)	RS48s (NPT) RS46s (BSP)	RS48s (NPT) RS46s (BSP)	RS1s	RS44s (NPT) RS43s (BSP)
4	CIRCLIP									
5	DRUM ASSEMBLY		RP35-Black	RP43-Black	RP35-Black	RP33-Black	RP35-Black	RP35-Black	RP33-Black	RP35-Black
6	OUTER CASE ASSEMBLY		RP36Cs*	RP36Cs*	RP36Cs*	RP36Cs*	RP36Cs*	RP36Cs*	RP36Cs*	RP36Cs*
7	OUTER CASE-PLAIN									
8	TENSION PLATE ASSEMBLY									
9	LATCHING PLATE ASSEMBLY		RP34s	RP34s	RP34s	RP34s	RP34s	RP34s	RP34s	RP34s
10	RATCHET PLATE									
11	CARRY HANDLE		order RP36Cs*	order RP36Cs*	order RP36Cs*	order RP36Cs*	order RP36Cs*	order RP36Cs*	order RP36Cs*	order RP36Cs*
12	SEAL SET		BS115-1K	BS115-1K	BS115-1K	BS115-1K	BS115-1K	BS115-1K	BS115-1K	
13	HOSE KIT ASSEMBLY (Includes hose stopper)		RH99s (BSP) RH101s (NPT)	RH35s (BSP) RH36s (NPT)	RH22s (BSP) RH17s (NPT)	RH86s (BSP) RH74s (NPT)	RH83s (BSP) RH87s (NPT)	RH40s (BSP) RH44s (NPT)	RH3s	RH45s (BSP) RH49s (NPT)
14	HOSE STOPPER		Z10s	Z10s	Z40s	Z10s	Z40s	Z40s	Z10s	Z10s
15	INLET SWIVEL ASSEMBLY		N/A	N/A	N/A	N/A	N/A	N/A	N/A	SB6s
16	INLET ADAPTOR		N/A	N/A	N/A	N/A	N/A	N/A	N/A	RS40s
17	BEARING SET incl SCREWS		N/A	N/A	N/A	N/A	N/A	N/A	N/A	RS36s
18	NOZZLE SET		N/A	N/A	N/A	N/A	N/A	RH51s	RH11s	N/A
	LOCKING BRACKET		RB9s	RB9s	RB9s	RB9s	RB9s	RB9s	RB9s	RB9s
	STANDARD WALL BRACKET		BU100	BU100	BU100	BU100	BU100	BU100	BU100	BU100
	FEEDER HOSE ASSEMBLY		N/A	N/A	N/A	N/A	N/A	N/A	RH12s	N/A

ITEM	DESCRIPTION	PART / SET	FR300	HW100	HWP100	OLP100	OMP100	PW100	WP100	OEV100
1	INLET SIDE PLATE		order RP34s	order RP34s	order RP34s	order RP34s	order RP34s	order RP34s	order RP34s	order RP34s
2	SWIVEL SHAFT									
3	SWIVEL BODY	Seals incl'd	RS105s (BSP)	RS52s (NPT) RS64s (BSP)	RS90s (NPT) RS85s (BSP)	RS51s (NPT) RS50s (BSP)	RS51s (NPT) RS50s (BSP)	RS46s (NPT) RS48s (BSP)	RS68s (NPT) RS67s (BSP)	RS51s (NPT) RS50s (BSP)
4	CIRCLIP									
5	DRUM ASSEMBLY		RP35-Black	RP35-Black	RP35-Black	RP35-Black	RP35-Black	RP35-Black	RP33-Black	RP35-Black
6	OUTER CASE ASSEMBLY		RP36Cs*	RP36Cs*	RP36Cs*	RP36Cs*	RP36Cs*	RP36Cs*	RP36Cs*	RP36Cs*
7	OUTER CASE-PLAIN									
8	TENSION PLATE ASSEMBLY									
9	LATCHING PLATE ASSEMBLY		RP34s	RP34s	RP34s	RP34s	RP34s	RP34s	RP34s	RP34s
10	RATCHET PLATE									
11	CARRY HANDLE		order RP36Cs*	order RP36Cs*	order RP36Cs*	order RP36Cs*	order RP36Cs*	order RP36Cs*	order RP36Cs*	order RP36Cs*
12	SEAL SET		BS115Es	BS115Es	RS85s (BSP) or RS90s (NPT)	BS115-1K	BS115-1K	BS115-1K	BS115Vs	BS115-1K
13	HOSE KIT ASSEMBLY (Includes hose stopper)		RH78s (BSP)	RH41s (BSP) RH46s (NPT)	RH64s (BSP)	RH81s (BSP) RH82s (NPT)	RH84s (BSP) RH85s (NPT)	RH100s (BSP) RH106s (NPT)	RH50s (BSP) RH63s (NPT)	RH88s
14	HOSE STOPPER		Z44s	Z40s	Z10s	Z40s	Z40s	Z40s	Z10s	Z40s
15	INLET SWIVEL ASSEMBLY		N/A	N/A	N/A	N/A	N/A	N/A	N/A	N/A
16	INLET ADAPTOR		N/A	N/A	N/A	N/A	N/A	N/A	N/A	N/A
17	BEARING SET incl SCREWS		N/A	N/A	N/A	N/A	N/A	N/A	N/A	N/A
18	NOZZLE SET		N/A	N/A	N/A	N/A	N/A	N/A	N/A	N/A
	LOCKING BRACKET		RB9s	RB9s	RB9s	RB9s	RB9s	RB9s	RB9s	RB9s
	STANDARD WALL BRACKET		BU100	BU100	BU100	BU100	BU100	BU100	BU100	BU100
	FEEDER HOSE ASSEMBLY									

\* Nominate color when ordering

## TROUBLE SHOOTING GUIDE

PROBLEM	REMEDY
<b>1. Hose will not retract</b>  1. Hose bunching.  2. Spring tension too light.  3. Replacement hose too heavy.	1. Pull hose out and rewind guiding the hose to avoid bunching. 2. Refer to "Spring tension and latch side plate removal". 3. Replace hose with recommended hose, refer to "Hose Replacement".
<b>2. Reel will not latch</b>  1. The hose has been pulled past the latching teeth.  2. Broken latching pawl or pawl spring.	1. Allow the reel to slowly retract after hearing the 1st, 2nd or 3rd click.1.  2. Replace broken components. Refer to "Spring Tension and Latch Side Plate Removal".
<b>3. Reel Leaks.</b>  1. Damaged Hose.  2. Loose fittings.  3. Worn swivel seals	1. Replace hose. Refer to "Hose Replacement".  2. Tighten Fitting. refer to "Removal / Replacement of inlet Connection Side Plate". 3. Refer to "Swivel Seal Replacement".

  
**macnaught**  
 Macnaught Pty Ltd  
 PO Box 90 Arncliffe NSW 2205 Australia  
 Telephone (02) 9567 0401  
 Facsimile (02) 9597 7773  
 Email: sales@macnaught.com.au  
 Web: www.macnaught.com.au

### macnaught warranty



1. Macnaught Pty Ltd ("Macnaught") warrants that all products manufactured by Macnaught and/or supplied by Macnaught under the "Macnaught" brand, excluding M-Series positive displacement meters ("Meters") and components subject to wear, will be free from any defects caused by faulty materials or workmanship ("Warranty") for a period of 5 years from the date of purchase of the product.

2. For products (excluding Meters) which carry the "Macnaughtdesign" endorsement, an additional Warranty period of 5 years applies to all mechanical components (excluding electronic and electrical components), giving a total Warranty period of 10 years.

3. For Meters, the Warranty period is 12 months from the date of purchase of the product.

4. For components contained in all products which are usually subject to wear from normal operation of the products (such as o-rings, seals, springs, hoses and batteries), the Warranty period is 12 months from the date of purchase of the relevant product.

5. For products and components which are not manufactured by Macnaught and are supplied by Macnaught under a brand name other than "Macnaught", the Warranty period is the longer of 12 months from the date of purchase of the relevant product and the period of the manufacturer's warranty.

6. The warranties contained in clauses 1, 2, 3, 4 and 5 above are conditional on the purchaser, during the relevant Warranty period:

- delivering to Macnaught a detailed notice setting out full details of any defect in any product and details of the date and place of purchase (together with copies of purchase receipts and/or other supporting documents), and
- at the purchaser's own cost, returning the defective product to the nearest authorised Macnaught service centre.

7. Subject to compliance by the purchaser with clause 6, Macnaught shall, at its option, repair or replace any product or component found defective by its inspection by reason of faulty materials or workmanship of Macnaught.

8. This Warranty does not cover the failure of products, parts or components which, in the sole judgment of the Macnaught, arises other than from faulty materials or workmanship of Macnaught, including misuse, abrasion, corrosion, negligence, accident, substitution of non-Macnaught parts, unauthorised modification, improper use, storage or handling, faulty installation or tampering by the purchaser or any third party.

9. If Macnaught's inspection discloses no defect in material or workmanship, repair or replacement and return (at Macnaught's sole option) will be made at customary charges, which will be advised to the purchaser.

10. Macnaught's liability and the purchaser's rights under this Warranty shall be limited to the repair or replacement of defective products or components and particular, shall not extend to any direct, special, indirect or consequential damage or losses of any other warranties.

11. The foregoing Warranty supersedes, voids and is in lieu of any other warranties.

This Warranty does not form part of, nor does it constitute, a contract between Macnaught and the end-user or purchaser. It is additional to any warranty given by the seller of the products. This Warranty does not exclude, limit, restrict or modify the non-excludable rights or remedies conferred upon the end-user or purchaser, or the non-excludable duties or liabilities imposed on the seller or Macnaught, by Part V, Division 2, 2A, and Part VA of the Trade Act 1974 (Commonwealth) or other rights conferred on the end-user or purchaser or duties or liabilities imposed upon Macnaught.